

DSH-300

DRAWING
(mm)

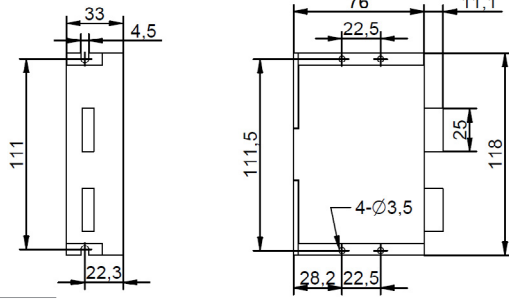

MODEL NO. DESIGNATION

DSH - CURRENT

Example: DSH-300

PHOTO



OPTIONS POWER SUPPLIES LRS SERIES



GENERAL

Model	Current	Weight	IP	Temperature range	Accessories
DSH-300	3 A	0.25 Kg	IP20	0 - 50 °C	Power supplies series Transmotec LRS series

FUNCTIONS

ALARM PWR	LED indicators	Green LED on	Power on
		Green LED flashes	Fault detection
DIR-	Motor direction signal	+5 V CW rotational direction	0 V CCW rotational direction
DIR+	Motor direction Vcc	+5 VDC to enable direction control	-
PUL-	Pulse signal	Driver input clock pulses (LO=0V, HI=5V) max pulse frequency 200 kHz	
PUL+	Pulse Vcc	+5 VDC to enable clock pulses	-
MF-	Motor enable signal	+5 V to enable rotation	0 V to disable rotation
MF+	Motor enable Vcc	+5 VDC to enable the enable operation	-
A- A+ B- B+	Motor phases connection		
V+ V-	Power supply 20-50 VDC GND		

CURRENT LIMIT SWITCH SETTINGS

Current RMS A	0.7	1.0	1.4	1.7	2.0	2.4	2.7	3.0
Current peak A	1.0	1.5	1.9	2.4	2.8	3.3	3.8	4.2
SW1	ON	OFF	ON	OFF	ON	OFF	ON	OFF
SW2	ON	ON	OFF	OFF	ON	ON	OFF	OFF
SW3	ON	ON	ON	ON	OFF	OFF	OFF	OFF

MICRO-STEP SWITCH SETTINGS

Micro-step/step	2	4	8	16	32	64	128	5	10	20	25	40	50	100	200
PUL/REV	400	800	1.6K	3.2K	6.4K	12.8K	25.6K	1K	2K	4K	5K	8K	10K	20K	40K
SW5	OFF	ON	OFF	ON	OFF	ON	OFF	ON	OFF	ON	OFF	ON	OFF	ON	OFF
SW6	ON	OFF	OFF	ON	ON	OFF	OFF	ON	ON	OFF	OFF	ON	ON	OFF	OFF
SW7	ON	ON	ON	OFF	OFF	OFF	OFF	ON	ON	ON	ON	OFF	OFF	OFF	OFF
SW8	ON	ON	ON	ON	ON	ON	ON	OFF	OFF	OFF	OFF	OFF	OFF	OFF	OFF

FUNCTION SWITCH SETTINGS

	ON-SETTING	OFF-SETTING
SW4	Full and half current	Half current when pulse time ≥ 200 ms

