

# WRD8089 / Ø 80mm / 126W / 126W

## DRAWING (mm)

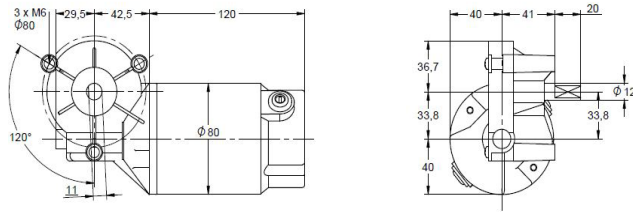

## PHOTO



## MODEL NO. DESIGNATION

WRD8089 - VOLTAGE - REDUCTION

Example: WRD8089-12-50

## ADDITIONAL

### GEAR MOTOR DATA

Reduction	50:1
Nominal torque 12 V (Nm) *	11
Nominal speed 12 V (rpm) *	70
Nominal torque 24 V (Nm) *	11
Nominal speed 24 V (rpm) *	70
Length (mm)	195
Weight (kg)	2.8

\* Nominal speed and nominal torque have a tolerance of  $\pm 15\%$

### GEAR HEAD DATA

Reduction	50:1
Max. continuous torque (Nm)	14
Intermittently permissible torque (Nm)	18
Efficiency (%)	65
Weight (kg)	0.8

### GEAR MOTOR FEATURES AND STANDARD DATA

	STANDARD	CUSTOMIZATION OPTIONS
Type	Worm gear brush dc gear motor	
Gear angle	Left	
Motor type	Iron core, brush commutation	Winding parameters
Motor brush type	Carbon brushes	
Motor terminals	Cable wires 200 mm	Wiring harnesses, cables, connectors
EMC filter	No	Yes
Gear	Plastic	Metal
Bearing	Ball bearing	
Shaft	Hardened stainless steel	Dimensions
Environmental protection	IP40	
Operating temperature	-10...+60 °C	-40...+60 °C
RoHS compliance	Yes	
CE label	No	Yes
UL approval	No	Yes
UL approval	No	Yes

### MOTOR DATA

Nominal voltage (V)	12	24
No load speed (rpm)	3800	3800
No load current (A)	3.0	1.5
Nominal speed (rpm)	3500	3500
Nominal torque (mNm)	343	343
Nominal current (A)	13	6.5
Stall torque (Nm)	3.1	3.1
Starting current (A)	111	56
Output (W)	126	126
Length (mm)	116	116
Weight (kg)	2	2