

SHC25-18 Series connector □ 25 mm

DRAWING (mm)

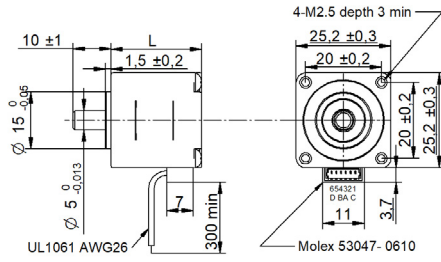

PHOTO



MODEL NAME DESIGNATION

SHC3520 - STEP ANGLE - CURRENT

Example: SHW35-09-100



OPTIONS MOTOR DRIVERS AND POWER SUPPLIES



MOTOR FEATURES

Step angle	1.8
Step angle accuracy	± 5% full step no load
Shaft material	X8CrNiS18-9 SUS303
Bearing type	Ball bearing
Radial play	0.02 mm 450 g
Axial play	0.08 mm 450 g
Max. radial force	28N 20 mm from shaft
Max. axial force	7N
Dielectric strength	600VAC 1 sec.
Insulation resistance	100MΩ 500VDC
Ambient temperature	-20° - (+50°)
Insulation class	Class B
IP rating	IP30
Connection harness	UL 1061 AWG26 300 mm
Connector	Molex 53047-0610

CUSTOMIZATION EXAMPLES

- Shaft configurations
- Bearing type and preload
- Temperature range
- IP rating
- Winding and performance optimization
- Cabling and harness
- Gear box to motor combinations
- Encoder to motor combinations

OPTIONS

- Stepper motor drivers Transmotec DS series
- Power supplies Transmotec LRS series

EXCITATION SEQUENCE TABLE

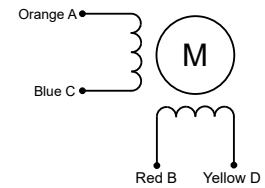

PIN	3	4	1	6
CW	A	C	B	D
1	●		●	
2		●	●	
3		●		●
4	●			●
1	●		●	

● = + Polarity

MOTOR DATA

Graph	A
Motor model	SHC2524-18-070
Holding torque mNm	33
Detent torque mNm	3.0
Rotor inertia gcm ²	2.0
Current phase A	0.70
Resistance phase Ω	4.00
Inductance mH	2.4
Length mm	24.0
Weight Kg	0.055

SPEED | TORQUE PERFORMANCE GRAPH PULL OUT

Graph	A
Supply voltage VDC	24
Current phase A	0.7

