

# F0837L (pull type)

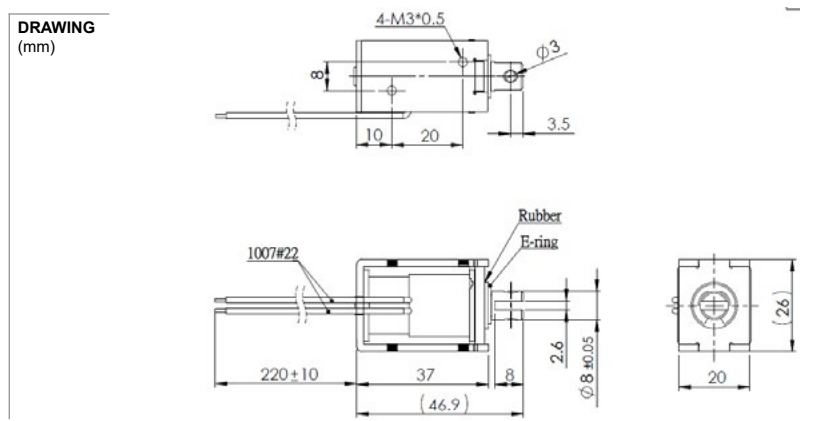

**MODEL NO. DESIGNATION**

F0837L - VOLTAGE

Example: F0837L-12V

**SOLENOID DATA**

Duty cycle / ED (%) ▶	Continuous (100%)	Intermittent (50%)	Intermittent (25%)	Intermittent (10%)
Watts @ 20°C ▶	4	8	16	40
Maximum time in energized state (in seconds) ▶	∞	100	36	7

Part ▼	Resistance (20°C) ± 10% (Ω) ▼	DC Volts (V) ▼			
F0837L-06V	9	6	8.5	12	19
F0837L-12V	36	12	17	24	38
F0837L-24V	144	24	34	48	76

**SOLENOID FEATURES AND STANDARD DATA**

	STANDARD	CUSTOMIZATION OPTIONS
Type	Pull type DC solenoid	Push type DC solenoid
Cable	Flying wire 230mm	Length, type and connector
Voltage	6 to 24 VDC @ 100% ED	Other voltages upon request
Life time	At least 500.000 single strokes	
Plunger material	Carbon steel 12L14	
Protection class	IP00	
Insulation grade	B	
Operating temperature	-5°C ... +40°C	
Manufacturing quality standards	ISO9001:2008, ISO/TS 16949:2002	
RoHS compliance	Yes	
CE approval	No	
UL approval	No	

**ADDITIONAL DATA**

Return spring	Yes
Weight	96g

**SPRING DATA**

Loading force @ 5mm compression	48 ± 5g
---------------------------------	---------

