

B8686 / Ø 86mm

DRAWING (mm)

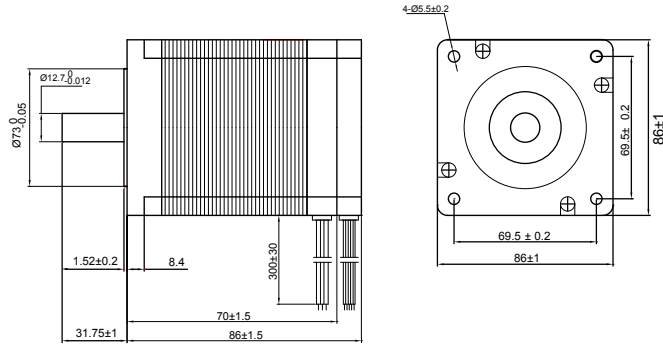

PHOTO



HALL CONNECTING

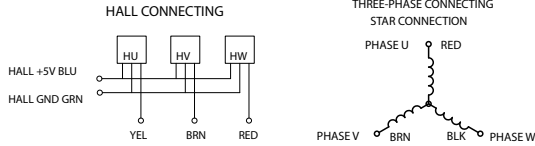

MODEL NO. DESIGNATION

MODEL - VOLTAGE

Example: B8686-12

MOTOR DATA

	Units	B8686-12	B8686-24	B8686-48		Units	B8686
Nominal voltage	V	12	24	48	Nominal voltage	V	12 24 48
Nominal power	W	116	225	228	Ambient temperature	°C	-15...+40
No load speed	rpm	2600	3900	3750	Max. permissible winding temperature	°C	140 140 120
No load current	mA	1800	1400	950	Max. permissible speed	rpm	5000
Nominal speed	rpm	1817	3062	3107	Axial play at axial load < 3,5 N	mm	0,1
Nominal torque	Nm	0.609	0.703	0.702	Axial play at axial load > 3,5 N	mm	0,6
Nominal current	A	14.43	13.76	6.61	Radial play	mm@g	0,02
Stall torque	Nm	2	3.2	4	Max. axial load (dynamic)	N	60
Starting current	A	51	56	34	Max. force for press fits (static)	N	560
Max. efficiency	%	75	70	73	Max. force for press fits (static, shaft)	N	2000
Terminal resistance phase to phase	Ω	0.056	0.091	0.34	Max. radial loading, 10 mm from flange	N	220
Terminal inductance phase to phase	mH	0.127	0.23	1	Number of pole pairs		4
Torque constant	Nm / A	0.04	0.059	0.12	Number of phases		3
Speed constant	rpm / V	217	162	78	Weight	g	2120
Speed / torque gradient	rpm / Nm	1300	1218	948			
Mechanical time constant	ms	11.1	12.7	8			
Rotor inertia	gcm ²	800	800	800			